

BA系列 BA Series 多回转型阀门手动装置 Multi-turn gear actuator

该装置是直接安装在闸阀和截止阀等阀门上的手动装置，该装置采用弧齿锥齿轮和平面推力轴承，有运转平稳、扭矩大、噪音小、效率高的优点。在所有的结合部，采用了密封垫全密封处理，达到了防水、防油漏的效果，防护等级为IP65。手轮和阀杆罩可根据用户需求定制。结合各类阀门使用要求及环境，还有单级带电连接、双级带电连接、双级手轮驱动等产品。

The gear actuator can be installed directly on the gate valve, globe valve and so on. By using Spiral bevel gears and thrust ball bearing, the gear actuator can run smoothly, and have high output torque, low noise and high efficiency. It can avoid from waterproof & oil leakage as sealing glands are used at all the through part. And the Protection grade can be IP65. The handwheel and the stem covers can be customized. For different valves and requirement, there are single stair gear actuator with motor flange, double stair gear actuator with motor flange and double stair gear actuator with handwheel etc.

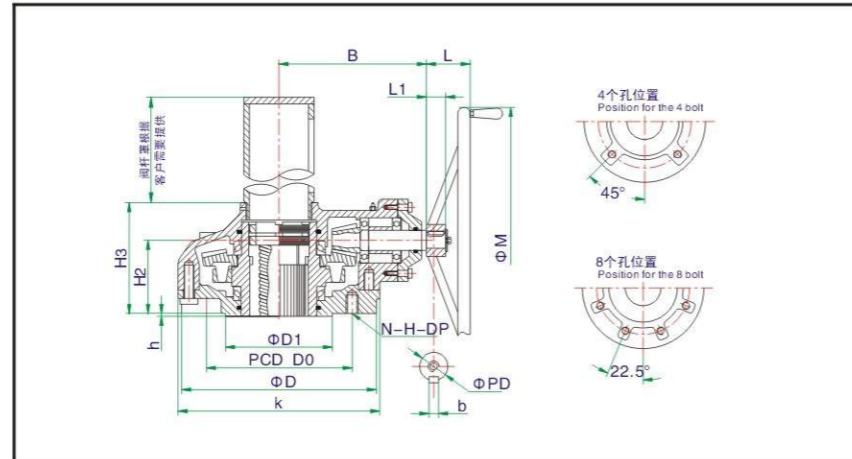

型号Model	MY-VS10	MY-VS20	MY-V0	MY-V1	MY-V2	MY-V3	MY-V35	MY-V5	MY-V6	
技术参数 Technical-parameters										
速比 Ratio	2.3:1	2.35:1	3.1:1	3.6:1	4:1	4.1:1	5:1	6.3:1	7.1:1	
最大推力 Max-thrust	N	75500	113000	127000	141000	190000	288000	352000	512000	1110000
	Kgf	7690	11500	12900	14400	19400	29400	35900	52200	113000
最大转矩 Max-torque	N·m	216	363	589	932	1491	2296	3404	4500	7250
	Kgf·m	22	37	60	95	152	234	347	459	740
最大阀杆直径 Max-stem dia. Mm	22	25	28	40	52	60	70	100	120	
参考重量 Weight Kg	10	12	21.5	28	35	50	95.5	190	288	
连接尺寸 Connection-size										
法兰号 FLANGE	F10	F12	F14	F16	F16	F25	F30	F35	F40	
法兰外圆(D)	125	150	175	210	250	300	350	415	475	
连接孔中心 PCD	D0	102	125	140	165	205	254	298	356	406
	N-H-DP	4-M10-15	4-M12-18	4-M16-24	4-M20-30	8-M16-24	8-M16-24	8-M20-30	8-M30-45	8-M36-54
凸面 Convex (D1 x h)	70 x 3	85 x 3	100 x 4	130 x 4	140 x 5	200 x 5	230 x 5	260 x 5	300 x 8	
外型尺寸 Appearance-size										
H1	38	46	55	62	75	85	105	145	165	
H2	65	70	70	75	90	100	140	155	210	
H3	110	125	128	145	160	170	225	280	335	
L	120	135	160	180	200	225	280	355	365	
L2	215	230	260	320	340	365	420	515	565	
手轮 hand wheel	PD	26	26	28	28	32	32	38	50	
	(b)key	87	8 x 7	8 x 7	8 x 7	10 x 8	10 x 8	10 x 8	2-16 x 10	
	L1	34	34	34	34	40	40	50	55	
	M	250	250	400	450	500	600	650	70	80

MY-V-S系列 MY-V-S Series 多回转型阀门手动装置 Multi-turn gear actuator

该装置是直接安装在闸阀和截止阀等阀门上的手动装置，该装置采用弧齿锥齿轮和平面推力轴承，有运转平稳、扭矩大、噪音小、效率高的优点。在所有的结合部，采用了密封垫全密封处理，达到了防水、防油漏的效果，防护等级为IP65。手轮和阀杆罩可根据用户需求定制。结合各类阀门使用要求及环境，还有单级带电连接、双级带电连接、双级手轮驱动等产品。

The gear actuator can be installed directly on the gate valve, globe valve and so on. By using Spiral bevel gears and thrust ball bearing, the gear actuator can run smoothly, and have high output torque, low noise and high efficiency. It can avoid from waterproof & oil leakage as sealing glands are used at all the through part. And the Protection grade can be IP65. The handwheel and the stem covers can be customized. For different valves and requirement, there are single stair gear actuator with motor flange, double stair gear actuator with motor flange and double stair gear actuator with handwheel etc.

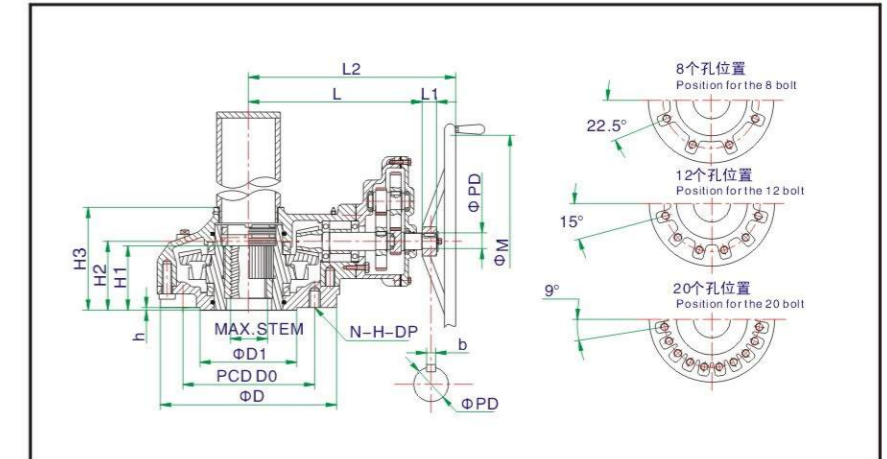

型号Model	MY-V2-1S	MY-V3-1S	MY-V35-1S	MY-V5-1S	MY-V6-1S	MY-V7-1S	MY-V8-1S	
技术参数 Technical-parameters								
速比 Ratio	12.2:1	18.1:1	23:1	42:1	46:1	94.4:1	115.5:1	
最大推力 Max-thrust	N	190000	280000	352000	512000	1110000	1430000	
	kgf	19400	29400	35900	52200	113000	146000	
最大转矩 Max-torque	N·m	2500	3500	5000	8200	14500	26100	
	Kgf·m	255	357	510	836	1479	2662	
最大阀杆直径 Max-stem dia. Mm	52	60	70	100	120	130	150	
参考重量 Weight Kg	52	70	119	265	328	470	645	
连接尺寸 Connection-size								
法兰号 FLANGE	(F20)	F25	F30	F35	F40	F48	F60	
法兰外圆(D)	250	300	350	415	475	560	686	
连接孔中心 PCD	D0	205	254	298	356	406	603	
	N-H-DP	8-M16-24	8-M16-24	8-M20-35	8-M30-45	8-M36-54	12-M36-54	20-M36-54
凸面 Convex (D1 x h)	140 x 5	200 x 5	230 x 5	260 x 5	300 x 8	370 x 8	470 x 8	
外型尺寸 Appearance-size								
H1	75	85	105	145	165	195	200	
H2	90	100	140	155	210	220	250	
H3	160	170	225	280	335	360	380	
L	305	330	390	480	500	550	610	
L2	445	470	550	655	675	750	810	
手轮 hand wheel	PD	28	28	28	38	38	45	45
	(b)key	8 x 7	8 x 7	8 x 7	10 x 8	10 x 8	12 x 8	12 x 8
	L1	40	40	40	50	50	50	50
	M	400	500	600	650	700	800	800